

Shelf Back Lavatory Fittings

for F 115

Built in china spout

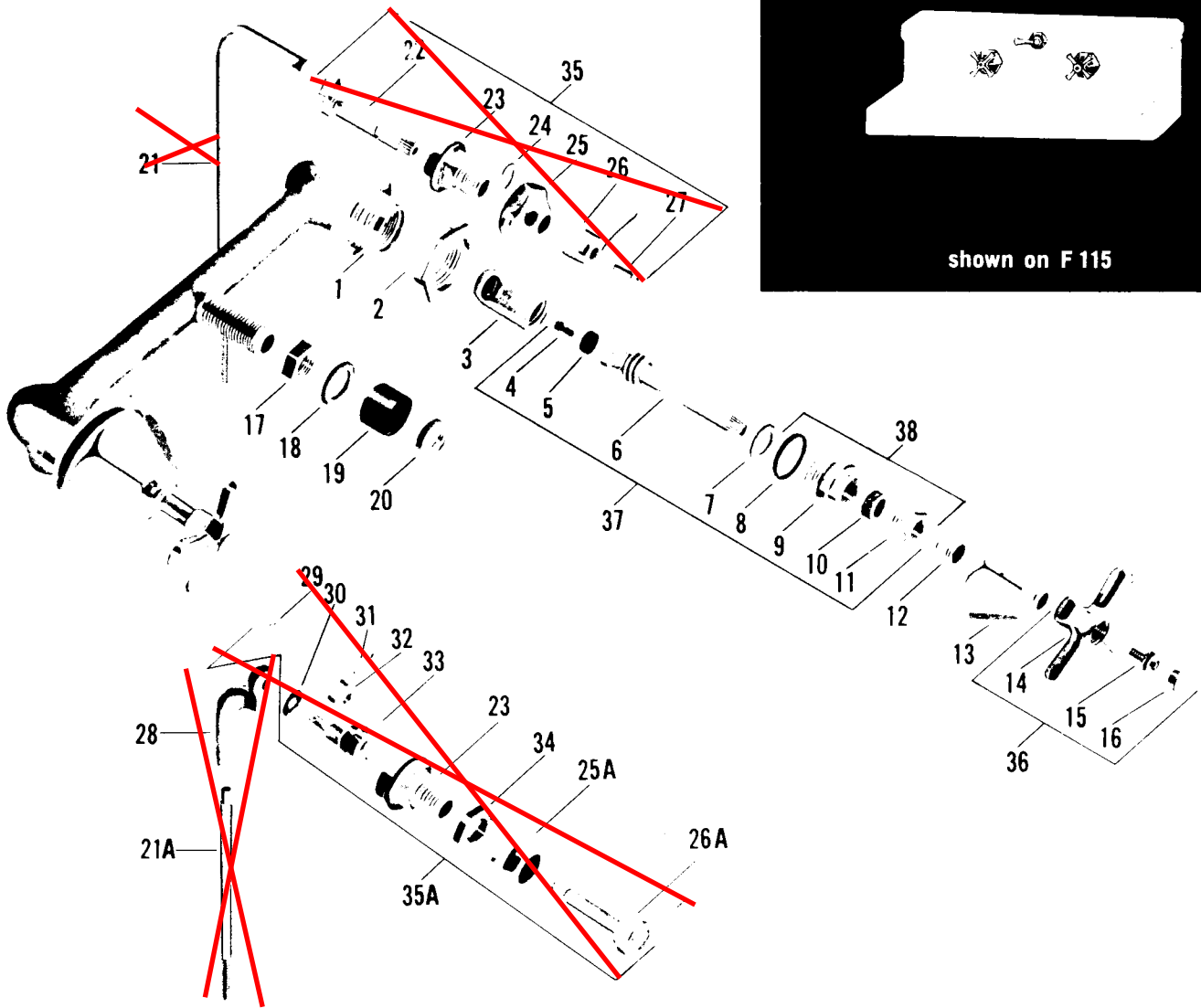

no.	description	part no.	F 115 with B 769 Type Drain	F 115 with B 767 Type Drain	no.	description	part no.	F 115 with B 769 Type Drain	F 115 with B 767 Type Drain
1	Body (One Piece)	67626-08			23	Spud	67647-08		
2	Spud Lock Nut	67633-08			23A	Spud	33153-08		
3	Re-Nu Sleeve - H or C	20336-08			24	Ring for Stem	67119-05		
4	Seat Washer Screw	159-17			25	Drain Valve Escutcheon	25892-02		
5	Seat Washer	441-07			25A	Drain Valve Escutcheon	1241-02		
6	Stem w/washer & Screw - H or C	19376-02			26	Drain Valve Handle	1055-12		
7	Brass Washer	1167-17			26A	Drain Valve Handle	1049-12		
8	Stuffing Box Washer	73-07			27	Drain Valve Handle Screw	173-01		
9	Stuffing Box	182-27			28	Lift Rod Socket	67629-08		
10	Stem Packing	1311-07			29	Cotter Pin	432-07		
11	Stuffing Nut	194-17			30	Brass Washer	21648-08		
12	Escutcheon Nipple	39995-05			31	Cotter Pin	431-07		
13	Escutcheon	1262-12			32	Castle Nut	1150-07		
14	Handle	1186-12			33	Eccentric	67638-08		
15	Screw	264-17			34	Lock Nut	25037-08		
16	Button - Specify Index	1255-12			35	Drain Valve S/A	8397-02		
17	Lock Nut	225-17			35A	Drain Valve S/A	8389-02		
18	Spreader Washer	220-17			36	Handle S/A - Specify Index	9171-02		
19	Expansion Washer	1249-07			37	Re-Nu Unit S/A	4782-02		
20	Collar	39628-08			38	Stuffing Box S/A	8111-08		
21	Lift Rod	25810-05							
21A	Lift Rod	46156-08							
22	Drain Valve Stem	70-35							
						Sub-assembly			
						Valve S/A - (Parts 1-12 & 17-20) - #8392-02			

Note - F 115 furnished complete with B 767 Type Drain under part #14952-02

For Pop-up Drain parts for F 115 with B 769 Type Drain refer to B 769 on page 156
 For Pop-up Drain parts for F 115 with B 767 Type Drain refer to B 767 on page 156

Plumbing Parts Depot
610-495-8790