

Central Brass

COMPANY

Brecksville, Ohio 44141

Phone: (216)883-0220 Fax: (440)526-5745

www.CentralBrass.com

MODEL NOS. **1137** **1138** Series

Cast Brass Centerset

Lavatory Faucet

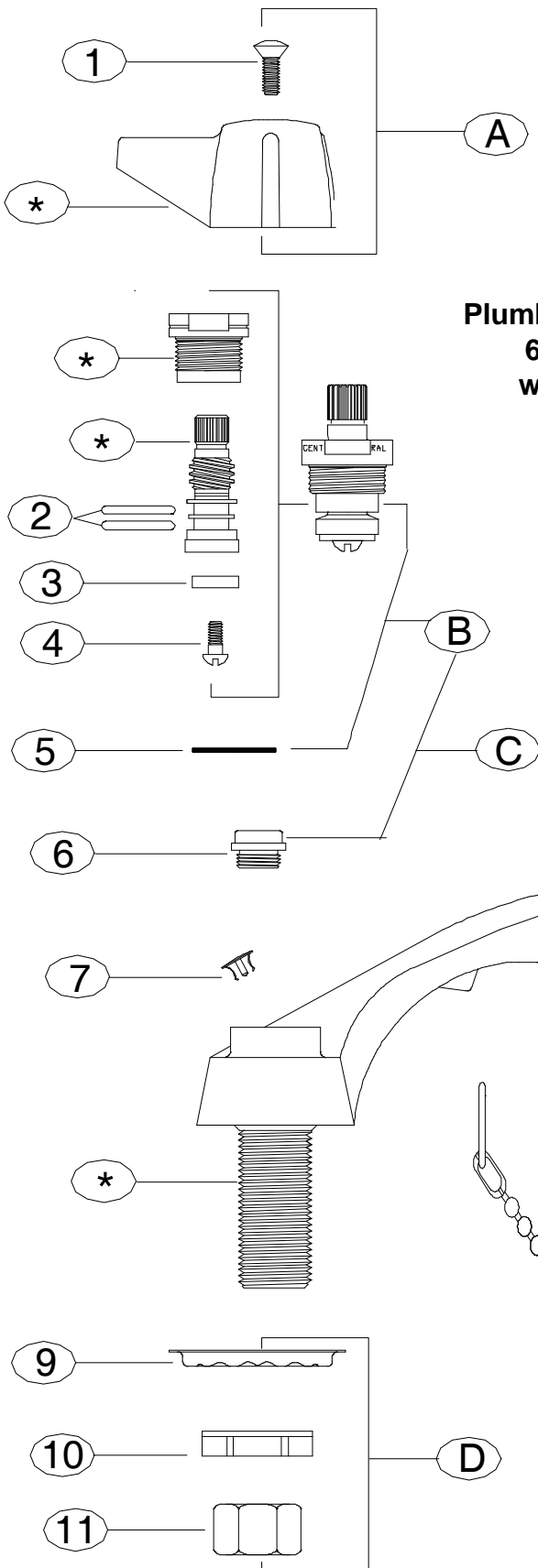

REPLACEMENT PARTS

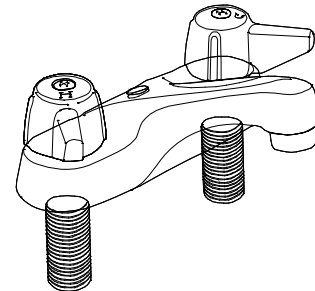

Plumbing Parts Depot
610-495-8790
www.ppd1.biz

NEW!!! Pop-up
Item Number 1109
is now supplied.
Part Number 1104 or 1105
was supplied with items
shipped before 7-1-2002

* These items are not offered individually and
must be purchased as a group or unit.
Please contact Central Brass for more information.

Central Brass

COMPANY

Brecksville, Ohio 44141

Phone:(216)883-0220 Fax: (440)526-5745

www.CentralBrass.com

MODEL NOS. **1137** **1138** Series

Cast Brass Centerset

Lavatory Faucet

Plumbing Parts Depot

610-495-8790

www.ppd1.biz

REPLACEMENT PARTS

#	Part #	Description
A	G-523-C	Lever Handle C Indexed with Screw (X107-F)
A	G-523-H	Lever Handle H Indexed with Screw (X107-F)
B	G-453-EL	Cold Stem Assembly with Gasket (X1028-Y)
B	G-453-ER	Hot Stem Assembly with Gasket (X1028-Y)
C	K-453-C	Cold Stem Assembly with Gasket (X1028-Y) and Seat (X263-BC)
C	K-453-H	Hot Stem Assembly with Gasket (X1028-Y) and Seat (X263-BC)
D	G-913-A	Coupling Nut group (2 sets)
D	G-95-A	Coupling Nut group (1 set)
1	X107-F	Handle Screw (25 pcs per pack)
2	X1038-453	O-Rings (25 pcs pack)
3	X901-WNN	Stem Seat Washer (25 pcs per pack)
4	X104	Seat Washer Screw (25 pcs per pack)
5	X1028-Y	Gasket (25 pcs per pack)
6	X263-BC	Replacement Seat (10 pcs per pack)
7	X70-WA	Plug Hole Button (6 pcs per pack) For items without Pop-up Drain
8	30-L	Aerator (Male)
9	X54	Crowfoot Washer (10 pcs per pack)
10	X7133-AZ	Locknut (10 pcs per pack)
11	X4015	Coupling Nut (4 pcs per pack)
12	G-192-UB	Ring, Chain & Stopper for item 1138 only

See **81137**, **101137**, **181137**, **201137**, & **281137** for items with more options including *Ceramic Stem Cartridges* and *Villager Lever Handles*

Central Brass

COMPANY

Brecksville, Ohio 44141

Phone:(216)883-0220 Fax: (440)526-5745

www.CentralBrass.com

MODEL NOS. 1137 1138 Series

Cast Brass Centerset

Lavatory Faucet

For 1137 Series ONLY

OPTIONS & REPLACEMENT PARTS

for options (see replacement part sheets for individual items)

Suffix Number	Replaces Item #	Part Number	Description
EL	A	G-4149-C	6-Inch Brass Wrist Handles – Index Blue (X107-FB)
EL	A	G-4149-H	6-Inch Brass Wrist Handles – Index Red (X107-FR)
ELS	A	G-4147-C	4-Inch Brass Wrist Handles – Index Blue (X107-FB)
ELS	A	G-4147-H	4-Inch Brass Wrist Handles – Index Red (X107-FR)
X	A	G-1143-C	Brass Canopy Handles – Index Blue (X107-FB) & Brass Locknut group (G-913-X)
X	A	G-1143-H	Brass Canopy Handles – Index Red (X107-FR) & Brass Locknut group (G-913-X)
		X107-FB	Blue Index (5 pcs per pack) Used for EL, ELS and X suffix's
		X107-FR	Red Index (5 pcs per pack) Used for EL, ELS and X suffix's
Q	B	G-454-EL	Quick-Pression Quarter-Turn Stem Cold with Gasket (X1028-Y)
Q	B	G-454-ER	Quick-Pression Quarter-Turn Stem Hot with Gasket (X1028-Y)
		X82-J	Brass Packing Washer for Quick-Pression Quarter-Turn stems (6 per pack)
	B & 8	K-352-C	Ceramic-disc Stem Cartridge Cold with gasket (X1028-Y)
	B & 8	K-352-H	Ceramic-disc Stem Cartridge Hot with gasket (X1028-Y)
Prefix Number	Replaces Item #	Part Number	Description
8	B & 8	K-352-C	Ceramic-disc Stem Cartridge Cold with Gasket (X1028-Y)
8	B & 8	K-352-H	Ceramic-disc Stem Cartridge Hot with Gasket (X1028-Y)
10 & 18	A	K-512-02	Handle Kit for Villager Collection with Chrome Lever (one pair)
10 & 18	A	K-512-15	Handle Kit for Villager Collection with White Lever (one pair)

- If faucet has round handles, use two Hot stem assemblies
- If faucet has lever handles, use one Hot and one Cold stem assemblies

See **81137, 101137, 181137, 201137, & 281137** for items with more options including *Ceramic Stem Cartridges* and *Villager Lever Handles*

Central Brass

COMPANY

Brecksville, Ohio 44141

Phone: (216) 883-0220 Fax: (440) 526-5745

www.CentralBrass.com

MODEL NOS. **1137** **1138** Series

Cast Brass Centerset

Lavatory Faucet

For items with
"D" Suffix
Pop-up Drain

NEW!!! Pop-up
Item Number 1109
is now supplied.

Part Number 1104 or 1105
was supplied with items
shipped before 7-1-2002

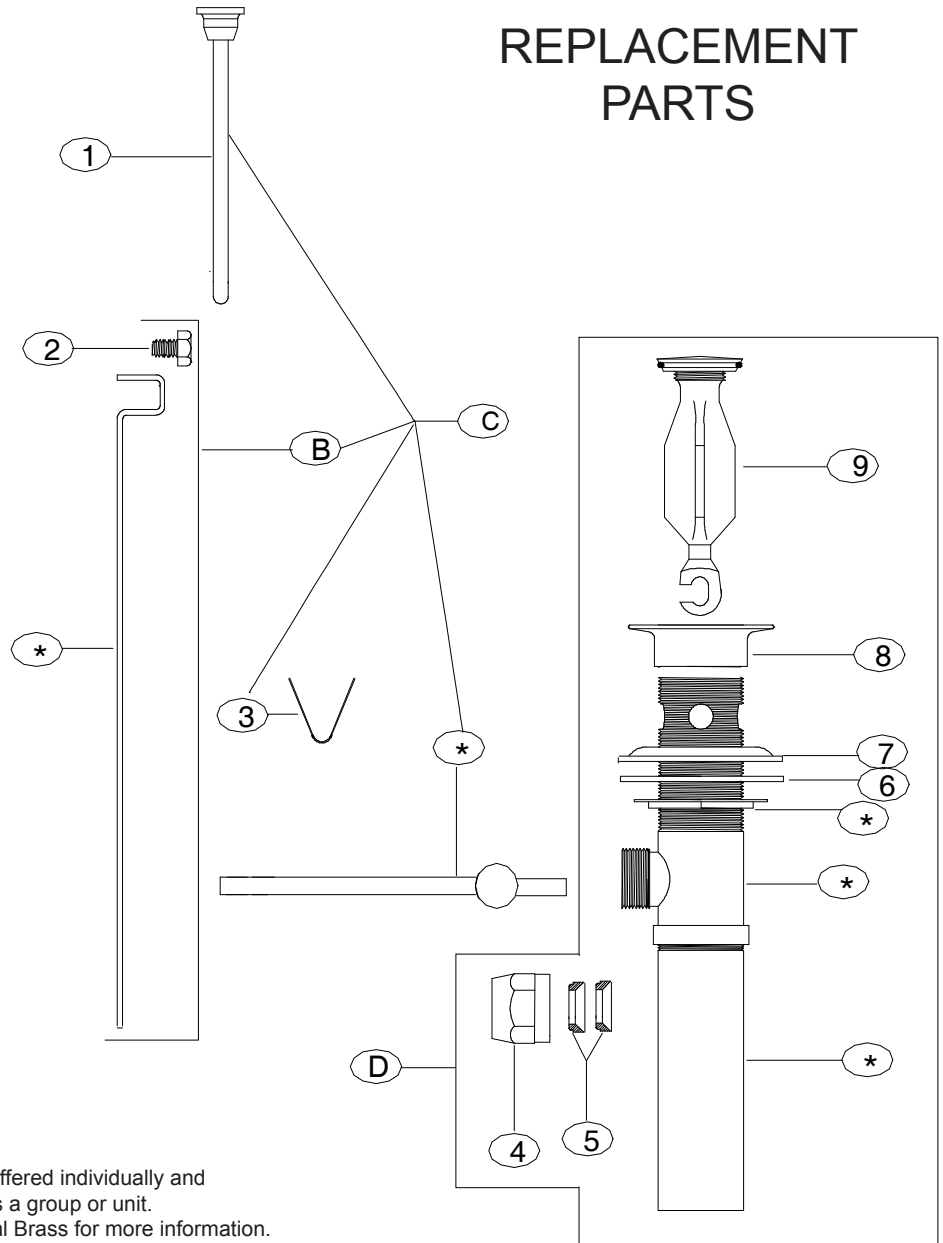
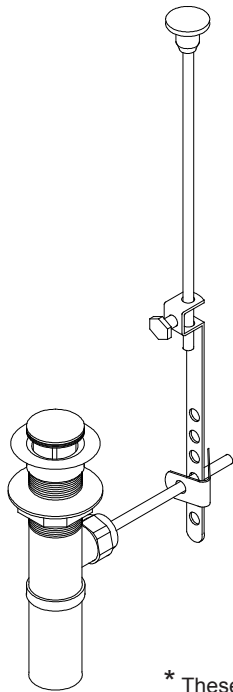

* These items are not offered individually and must be purchased as a group or unit. Please contact Central Brass for more information.

#	Part #	Description
B	SU-195	Pop-up Bracket with Screw (X113-P)
C	G-195-DST9	Pull Rod Group with Pop-up Bracket (SU-195) & Ball Lever Rod
D	SU-1109	Pop-up Drain less pull rod & bracket with Stopper & Guide (SU-2113-TT)
1	SU-195-BT9	Pull Rod & Knob
2	X113-P	Pop-up Bracket Screw (6 pcs per pack)
3	X195-C	Clip (6 pcs per pack)
4	192-NBB	Ball Lever Nut
5	X409-PT	Ball Lever Packing (12 pcs per pack)
6	X51-D	Washer (10 pcs per pack)
7	X994-1109	Mac Washer (4 pcs per pack)
8	2056-SPT1109	Top Flange
9	G-2115-TP	Stopper & Guide